





SC TYPE



RDA-20SC



RDA-25SC□



RDA-40SC□



RDA-42SC



RDA-52SC

SC 7 3/4" 3" -

NBR

: NBR  
 : -20° ~+85°  
 : -20° ~+60°

F (155° )

(DIN 43650A)

EN 60204.1 VDE 0580

IP65 (EN60529)

24

110

- 50/60Hz

220

- 50/60Hz

12

---17VA

---14.5VA

-20°C ~ +50°C

	( )	-	Kv ( 3/ )	v ( / )	( )	( )
RDA-20SC	3/4"	1	12.04	14	0.3~8.6	0.51
RDA-25SC	1"	1	19.78	23	0.3~8.6	0.40
RDA-40SC	1-1/2"	1	36.12	42	0.3~8.6	0.91
RDA-42SC	1-1/2"	2	43.86	51	0.3~8.6	1.0
RDA-52SC	2"	2	91.16	106	0.3~8.6	1.9
RDA-62SC	2-1/2"	2	116.96	136	0.3~8.6	2.5
RDA-72SC	3"	2	143.62	167	0.3~8.6	3.0



SC TYPE

Model: RDA-□□SC

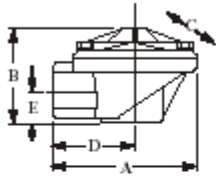

Model: RDA-42SC

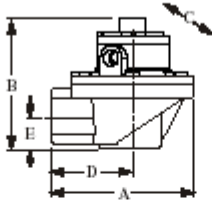

Model: RDA-□2SC

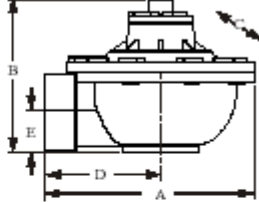

Model: RDA-□□SC□

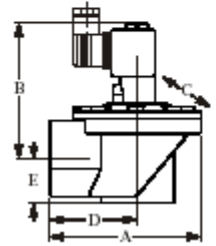

Model: RDA-42SC□

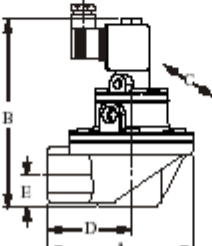

Model: RDA-□2SC□

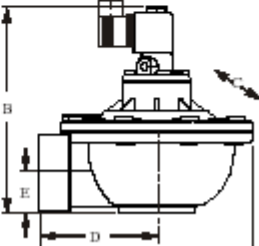

Valve Model	A		B		C (wide)		D		E	
	inch	mm	inch	mm	inch	mm	inch	mm	inch	Mm
RDA-20SC	3.95	100	2.97	75	3.44	87	2.19	56	0.78	20
RDA-25SC	4.13	105	3	76	3.25	83	2.50	64	0.87	22
RDA-40SC	3.95	130	4.91	125	4.37	111	4.5	75	1.28	36
RDA-42SC	3.95	130	5.16	131	4.37	111	4.5	75	1.28	36
RDA-52SC	8.07	205	5.87	149	7.24	184	4.45	113	1.55	40
RDA-62SC	8.27	210	6.69	170	7.24	184	4.65	118	1.89	48
RDA-72SC	8.58	218	7.83	199	7.87	200	4.65	118	2.48	63
RDA-20SC□	3.95	100	4.8	122	3.44	87	2.19	56	0.78	20
RDA-25SC□	4.13	105	4.96	126	3.25	83	2.50	64	0.87	22
RDA-40SC□	3.95	130	6.06	154	4.37	111	4.5	76	1.28	36
RDA-42SC□	3.95	130	7.20	183	4.37	111	4.5	75	1.28	36
RDA-52SC□	8.07	205	7.91	201	7.24	184	4.45	113	1.55	40
RDA-62SC□	8.27	210	8.74	222	7.24	184	4.65	118	1.89	48
RDA-72SC□	8.58	218	9.88	251	7.87	200	4.65	118	2.48	63

RDA-□□ SC □

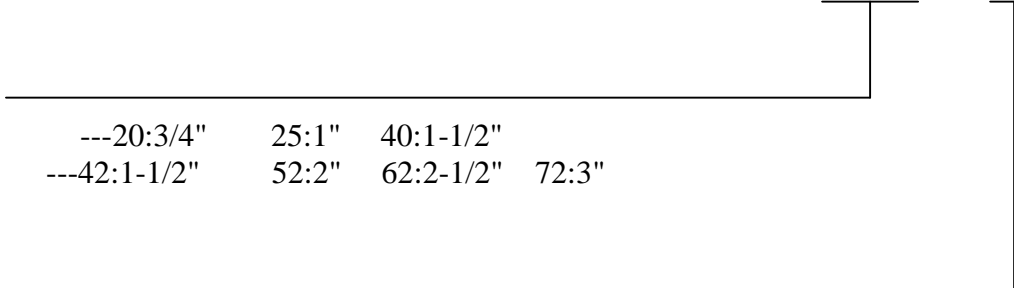

---20:3/4"    25:1"    40:1-1/2"  
 ---42:1-1/2"    52:2"    62:2-1/2"    72:3"

:    ----- 1:110VAC    2:220VAC    3:24VDC  
       ---- 5:110VAC    6:220VAC    7:24VDC



NC TYPE



RDA-20NC



RDA-25NC



RDA-20NC□ (1~3)



RDA-20NC□ (5~7)

NC -

NBR

: NBR  
: -20° ~+85°  
: -20° ~+60°

F (155° )

(DIN 43650A)

EN 60204.1 VDE 0580

IP65 (EN60529)

24

110

- 50/60Hz

220

- 50/60Hz

12

---17VA

---14.5VA

-20°C ~ +50°C

	( )	-	Kv ( <sup>3</sup> / )	v ( / )	( )	( )
RDA-20NC	3/4"	1	12.04	14	0.3~8.6	0.62
RDA-25NC	1"	1	19.78	23	0.3~8.6	0.96
RDA-40NC	1-1/2"	1	36.12	42	0.3~8.6	1.1
RDA-42NC	1-1/2"	2	43.86	51	0.3~8.6	1.45



NC TYPE

Model: RDA-□□NC

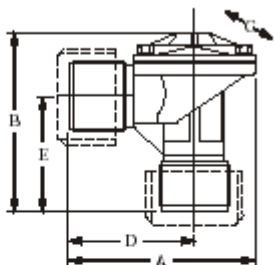

Model: RDA-42NC

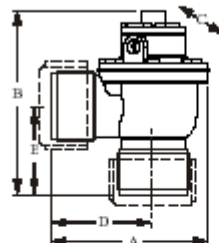

Model: RDA-□□NC□

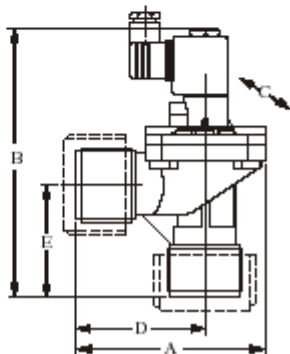

Model: RDA-42NC□

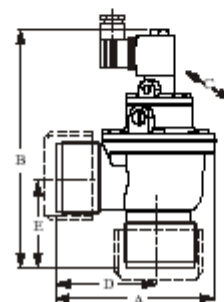

Model	A		B		C (wide)		D		E	
	inch	mm	inch	mm	inch	mm	inch	mm	inch	Mm
RDA-20NC	4.41	112	4	102	3.44	87	2.63	67	1.78	45
RDA-25NC	4.62	117	5	127	3.25	83	3	76	2.75	70
RDA-40NC	5.78	147	5.47	139	4.37	111	3.6	92	3	76
RDA-42NC	5.78	147	6.77	172	4.37	111	3.6	92	3	76
RDA-20NC□	4.41	112	5.83	148	3.43	87	2.63	67	1.87	45
RDA-25NC□	4.62	117	6.96	177	3.25	83	3	76	2.75	70
RDA-40NC□	5.78	147	7.64	194	4.37	111	3.6	92	3	76
RDA-42NC□	5.78	147	8.82	224	4.37	111	3.6	92	3	76

RDA-□□ NC □

---20:3/4"    25:1"    40:1-1/2"  
 ---42:1-1/2"    52:2"    62:2-1/2"    72:3"

: ----- 1:110VAC    2:220VAC    3:24VDC  
 : ----- 5:110VAC    6:220VAC    7:24VDC

UC TYPE



RDA-25UC



RDA-40UC

UC

1" 1-1/2"

SUS 316.

SUS316  
SUS316

NBR

: NBR  
: -20° ~+85°  
: -20° ~+60°

F (155° )

(DIN 43650A)

EN 60204.1 VDE 0580

IP65 (EN60529)

24

110

- 50/60Hz

220

- 50/60Hz

12

---17VA

---14.5VA

-20°C ~ +50°C

	( )	-	Kv ( 3/ )	v ( / )	( )	( )
RDA-25UC	1"	1	19.78	23	0.3~8.6	1.8
RDA-40UC	1-1/2"	1	36.12	42	0.3~8.6	2.7



UC TYPE

Model: RDA-□□UC

Model: RDA-□□UC□

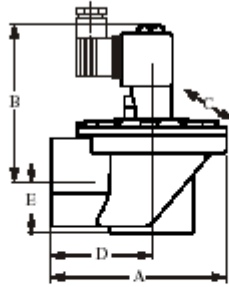
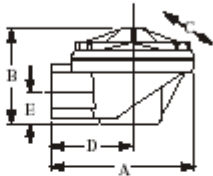

Model	A		B		C (wide)		D		E	
	inch	mm	inch	mm	inch	mm	inch	mm	inch	Mm
RDA-25UC	4.13	105	3	76	3.25	83	2.50	64	0.87	22
RDA-40UC	3.95	130	4.91	125	4.37	111	4.5	75	1.28	36
RDA-25UC□	4.13	105	4.96	126	3.25	83	2.50	64	0.87	22
RDA-40UC□	3.95	130	6.06	154	4.37	111	4.5	76	1.28	36

RDA- □ □ UC □

25:1" 40:1-1/2"

: ----- 1 : 110VAC 2 : 220VAC 3 : 24VDC  
 : -----5 : 110VAC 6 : 220VAC 7 : 24VDC



MC TYPE



NBR

: NBR  
 : -20° ~+85°  
 : -20° ~+60°

F (155° )

(DIN 43650A)

EN 60204.1 VDE 0580

IP65 (EN60529)

24

110

220

12

-50/ 60Hz

- 50/60Hz

---17VA

---14.5VA

-20°C ~ +50°C

	( )	-	Kv ( <sup>3</sup> / )	v ( / )	( )	( )
RDA-25 C	1"	1	19.78	23	0.3~8.6	0.35
RDA-42 C	1-1/2"	2	43.86	51	0.3~8.6	0.65
RDA-52 C	2"	2	91.16	106	0.3~8.6	1.2
RDA-62 C	2-1/2"	2	116.96	136	0.3~8.6	1.8
RDA-72 C	3"	2	143.62	167	0.3~8.6	2.3



:  
 : NBR  
 : -20° ~+85°  
 : -20° ~+60°  
 : 1~3

:  
 :  
 :  
 :  
 : NBR

F (155° )

(DIN 43650A)

EN 60204.1 VDE 0580

IP65 (EN60529)

24

110 - 50/60Hz

220 - 50/60Hz

12

---17VA

---14.5VA

-20°C ~ +50°C

Model: RDB-V (W) □

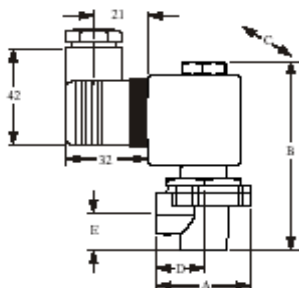

RDB-V□	1/8"PT	1	2~8.6	
RDB-W□	1/4"PT	1	2~8.6	

□ - (1~3), :

1:110VAC 2:220VAC 3:24VDC



ENCLOSURE



IP65.

3

NBR

: NBR  
 : -20° ~+85°  
 : -20° ~+60°  
 : 1~3

F (155° )

(DIN 43650A)

EN 60204.1 VDE 0580  
 IP65 (EN60529)  
 -20°C ~ +50°C

	-	.	-	( )	( )
RDB-06V□	1/4"	1/8"	6	2,3,4,5,6	0.3~8.6
RDB-12V□	1/4"	1/8"	12	7,8,9,10,11,12	0.3~8.6
RDB-06W□	1/4"	1/4"	6	2,3,4,5,6	0.3~8.6
RDB-12W□	1/4"	1/4"	12	7,8,9,10,11,12	0.3~8.6



Model: RDB-06□

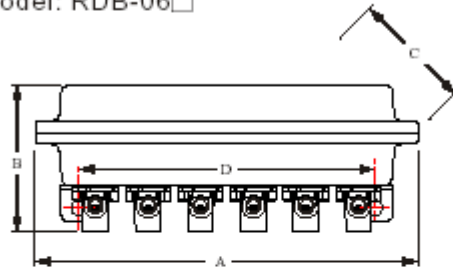

Model: RDB-12□

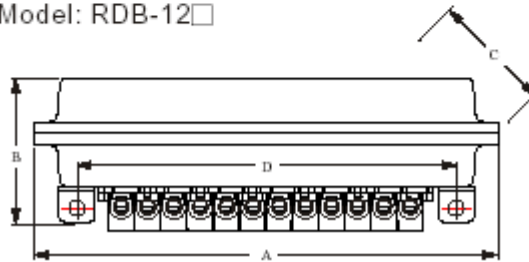

	PILOT	( )	( )	( )	D ( )
RDB-06V□	6	258	101.5	118	201
RDB-12V□	12	316	101.5	168	259
RDB-06W□	6	276	97.5	136	201
RDB-12W□	12	334	97.5	18	259

□ - , (1~3), :  
 1 : 110VAC    2 : 220VAC    3 : 24VDC  
 W -



DIN :  
 :  
 :  
 : SS41  
 : NBR (std.)  
 VITON ( )

Model: RDB-□□D

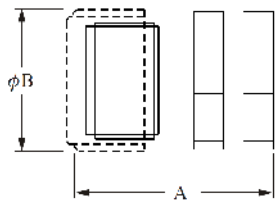

Model: RDB-□□DD

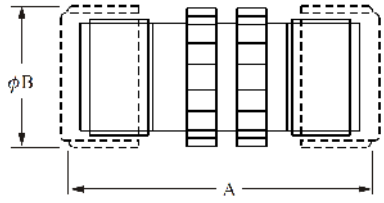

Model	Orifice	A(mm)	B(mm)	φD(mm)	L(mm)
RDB-20D	3/4"	60,5	58,5	45-51	97
RDB-20DD	3/4"	91	58,5	45-51	97
RDB-25D	1"	69	70	56-62	118
RDB-25DD	1"	101	70	56-62	118
RDB-40D	1-1/2"	75	88	72-78	157
RDB-40DD	1-1/2"	110	88	72-78	157

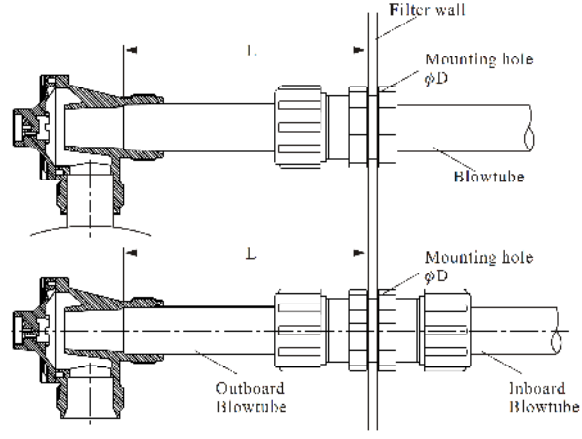

RDB-□□D

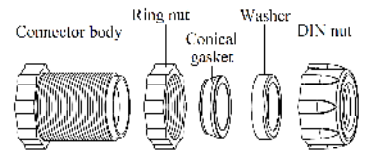

RDB-□□DD

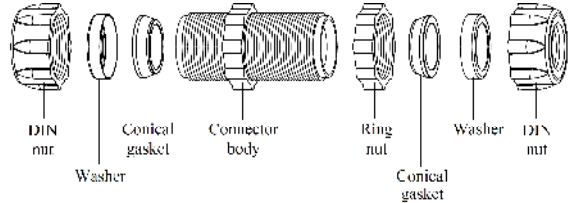

Filter wall –  
 Mounting hole–  
 Outboard blowtube –  
 Inboard blowtube –  
 Connector body –  
 Ring nut –  
 Conical gasket –  
 Washer –  
 DIN nut –



**AE410A**

**AE520D**

- :  
AE410A---110V/220VAC, ±20% 50Hz/60Hz  
AE520D---24V DC
- : 2s~60s  
: 20ms~200ms
- : 3
- : 2- 10-
- : 0~50°

\* **AE410A** (10 points)



\* **AE520D** (10 points)





110 /120 /140

.1- -

.2-

(R,C,A)

- 
- 
- 
- 
- 





\*AE120A (20 points)



\*AE110A (10 points)



\*AE140A (40 points)



- . : 110V/220V, A20% 50Hz/60Hz
- : 1s~999s
- : 10ms~9.99s
- : 3A
- : 1~10/20/40
- : 0~70°C
- : 2
- : 0~99